

The information contained in this drawing is the sole property of Coil Winding Specialist Inc (CWS). Any reproduction in part or whole without written permission of CWS is prohibited.

## F-114-61

### Features

NiZn ferrite material with a range for inductive applications up to 25 MHz, that can be used for EMI applications to suppress noise frequencies above 200 MHz.

Burnished to break sharp edges, can contain Parylene C coat at smaller diameters from the length of 9.5mm (0.375") or a uniform coating of thermo-set plastic at larger dimensions (if part numbers ends with a C).

REVISION HISTORY					
REV	ECN	DESCRIPTION	SIGN & DATE		
			BY	DATE	AP. DATE
A		Production release	EO	1/31/13	JL 1/31/13

Electrical Specifications				
Item	Unit/Symbol	Condition	Value	Tol.
A <sub>L</sub>	nH/N <sup>2</sup>	@ 10 KHz	80	± 25%
L <sub>c</sub>	cm	N/A	7.3	± 10%
A <sub>e</sub>	cm <sup>2</sup>	N/A	0.37	± 10%
V <sub>e</sub>	cm <sup>3</sup>	N/A	2.7	± 10%
Initial Permeability	μ <sub>0</sub>	@ B < 10 gauss	125	± 25%
Temp. Coeff. Of initial Permeability	%, °C	20 - 70 °C	0.1	Typ.
Coercive Force	H <sub>c</sub>	oersted	1.8	Typ.
Residual Flux Density	Gauss, B <sub>r</sub>	N/A	1200	Typ.
Flux Density	Gauss, B	Initial (B), oersted	2350	Typ.
	Gauss, H	@ Field Strength (H), oersted	15	Typ.
Curie temperature	°C	T <sub>c</sub>	> 300	Nom.
Resistivity	Ω cm, ρ	@ Field Strength	10 <sup>8</sup>	Typ.
Loss Factor	10 <sup>-6</sup> , tanδ / μ	Initial	30	Typ.
	MHz	@ Frequency	1	Typ.

Dimensional Tolerances				
	in	tol.	mm	tol.
Case				
B (Outer Diameter)	1.142	± 0.026	29.00	± 0.65
A (Inner Diameter)	0.748	± 0.020	19.00	± 0.50
H (Height)	0.285	± 0.010	7.50	± 0.25
Weight	13.00 g			

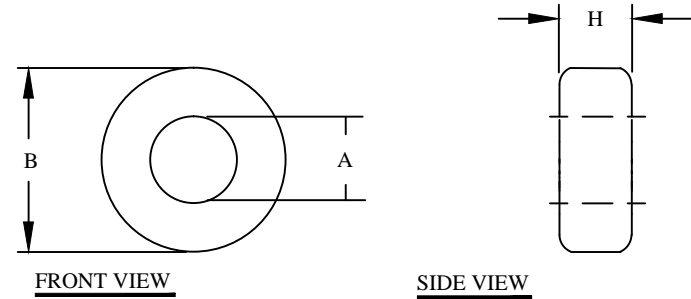

**For additional detail, specifications and charts see:**

[http://www.bytemark.com/products/ferrite\\_matl.htm](http://www.bytemark.com/products/ferrite_matl.htm)

CODE IDENT	MFG. P/N	DESCRIPTION	ITEM NO.
		<b>PARTS LIST</b>	
AUTOCAD	X	www.coilws.com www.cwsbytemark.com	CWSBYTEMARK 353 West Grove Ave. Orange, CA. 92865
SOLIDWORKS			
DRAWN	EO 1/31/13	TITLE: Ferrite Toroid Core Material 61, NiZn	
CHECKED	JL 1/31/13	SIZE	DWG. NO.
ENGR.	JL 1/31/13	B	F-114-61
APPR.	JL 1/31/13	SCALE	N/A
UNLESS OTHERWISE SPECIFIED		SHEET 1 OF 1	
DIMENSIONING AND TOLERANCE PER ANSI Y14.5M		REV A	
ALL DIMENSIONS ARE IN INCHES AND [MILLIMETERS].			
TOLERANCE INCHES: .XXX=±.005 .XX=±.015 <math>\angle</math>=±0°30'			
TOLERANCE METRICS: .XXX=±.127 .XX=±.38 <math>\angle</math>=±0°30'			
ANGLE PROJECTION			
DO NOT SCALE DRAWING			