

CN120-80-30G

| REVISION HISTORY | | SIGN & DATE | | | | |
|------------------|-----|--------------------|----|---------|-----|---------|
| REV | ECN | DESCRIPTION | BY | DATE | AP. | DATE |
| A | | Production release | EO | 1/21/13 | JL | 1/21/13 |

Features

- High Permeability (30-80K), high impedance Z and high insertion attenuation
- Suppresses the asymmetrical EMI currents
- High saturation Flux density can reduce over voltage peaks
- High Curie Temperature and excellent temperature characteristics

| Electrical Specifications | | | | |
|---------------------------|-------------------|---------------|-------|-------|
| Item | Units | Condition | Value | Tol. |
| A_L | nH/N ² | @ 1KHz, 200mV | 73700 | ± 25% |
| A_L | nH/N ² | @ 10KHz | 69800 | ± 25% |
| A_L | nH/N ² | @ 100KHz | 22900 | ± 25% |
| Permeability | μ_0 | @ 10 KHz | 35000 | ± 25% |
| A_e | cm ² | N/A | 6.00 | ± 10% |
| L_e | cm | N/A | 31.4 | ± 10% |
| Saturation Current | mA | @ 10 KHz | 100 | ± 20 |
| Saturation Flux Density | T | N/A | 1.2 | Max. |
| Curie temperature | °C | N/A | 580 | Nom. |

| Dimensional Tolerances | | | | |
|------------------------|------------|-------|-----|------|
| | in | tol. | mm | tol. |
| Core | | | | |
| B (Outer Diameter) | 4.72 | ±0.40 | 120 | ±1 |
| H (Height) | 1.18 | ±0.40 | 30 | ±1 |
| A (Inner Diameter) | 3.15 | ±0.40 | 80 | ±1 |
| Case | | | | |
| B (Outer Diameter) | 4.92 | ±0.40 | 125 | ±1 |
| H (Height) | 1.40 | ±0.40 | 36 | ±1 |
| A (Inner Diameter) | 2.95 | ±0.40 | 75 | ±1 |
| Weight | 1,060.00 g | | | |

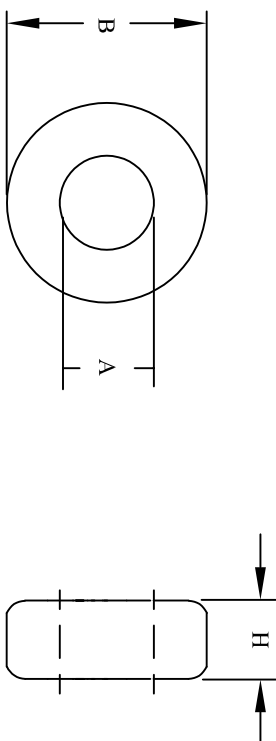

For additional detail, specifications and charts see:

- http://www.bytemark.com/products/comp_nanoc_cmhoke.html
- http://www.bytemark.com/products/Nanocrystalline_cores.html

| CODE IDENT | MFG. P/N | DESCRIPTION | ITEM NO. |
|---|------------|---------------------------------------|--|
| PARTS LIST | | | |
| AUTOCAD SOLIDWORKS SIGN | X | www.coliws.com www.cwsbytemark.com | CWSBYTEMARK 353 West Grove Ave. Orange, CA 92865 |
| UNLESS OTHERWISE SPECIFIED | | | |
| DIMENSIONING AND TOLERANCE PER ANSI Y14.5M AND [MILLIMETERS]. | DRAWN E.O. | DATE 1/21/13 | TITLE: Nanocrystalline Core |
| TOLERANCE INCHES: .XXX±.005 .XX±.015 .XX±.127 .XX±.38 | ENGR. JL | 1/21/13 | SIZE DIM. NO. B |
| ANGLE PROJECTION DO NOT SCALE DRAWING | APPR. JL | 1/21/13 | CN120-80-30G |
| | | | SCALE N/A |
| | | | SHEET 1 OF 1 |
| | | | REV A |